

DWG NO DA03125 SH 2 REV. -

SAGEBRUSH Technology, Inc.
A wholly-owned subsidiary of HexPath Technologies, Inc.

DRAWN V. SANCHEZ	SIZE D	CAGE CODE OXTY1	DWG NO. DA03125	REV. -
CHECKED S. SETHI	SCALE	SHEET 2		

DWG NO	DA03125	SH	1	REV.	-
REVISION HISTORY					
REV	DESCRIPTION	DATE	APPROVED		
	ORIGINAL RELEASE	6/27/01	A.S.		

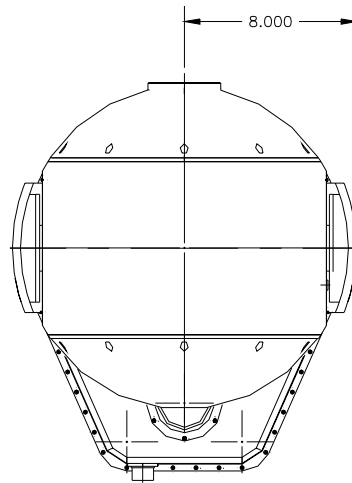
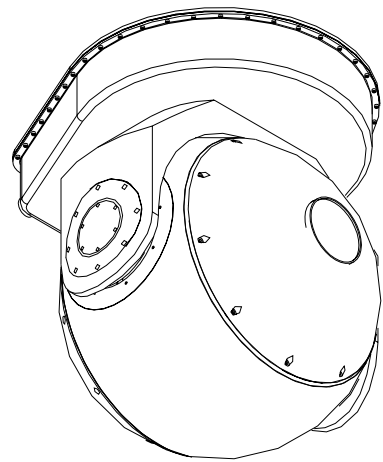
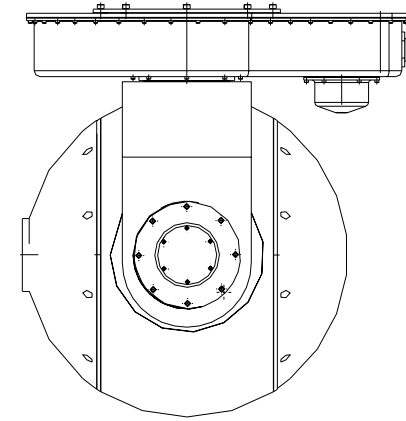
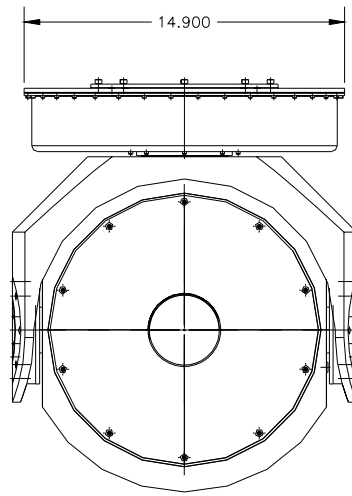
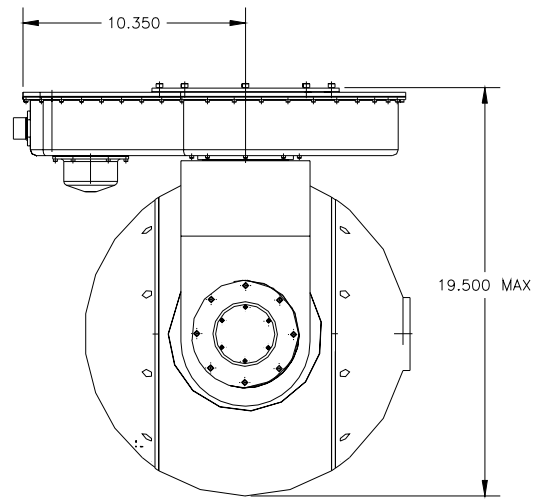
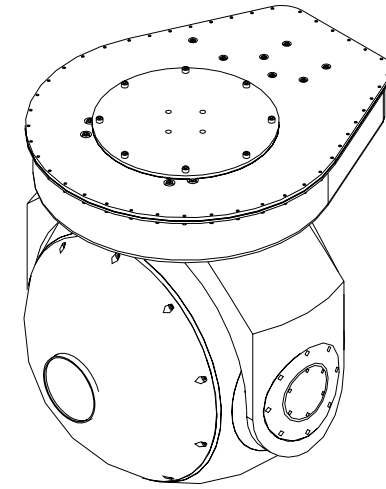
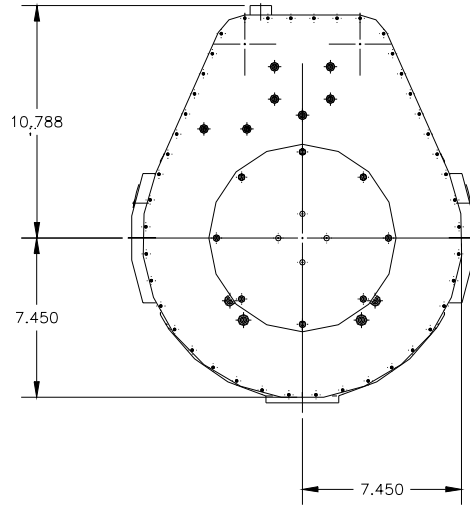
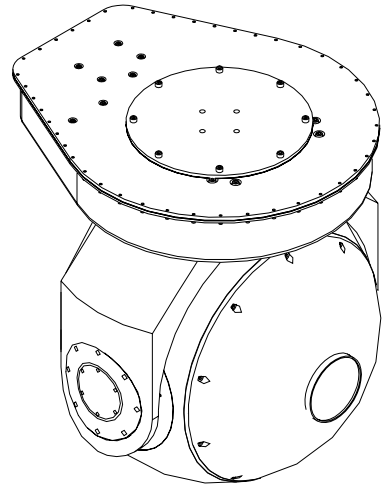

THIS IS A SAGEBRUSH TECHNOLOGY, INC. PROPRIETARY DOCUMENT AND IS ISSUED IN CONFIDENCE FOR ENGINEERING INFORMATION ONLY. IT MAY NOT BE REPRODUCED OR USED TO MANUFACTURE ANYTHING SHOWN HEREIN WITHOUT DIRECT WRITTEN PERMISSION FROM SAGEBRUSH TECHNOLOGY, INC. TO THE USER.

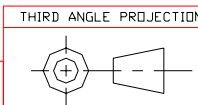

HEAT TREAT	NONE
FINISH	
MATL	

UNLESS OTHERWISE SPECIFIED:
 ◦ DIMENSIONS ARE IN INCHES AND APPLY PRIOR TO FINISH.
 ◦ SURFACE TEXTURE:
 ◦ SYMBOLS PER ANSI Y14.5M '94
 ◦ REQUIREMENTS PER ANSI B46.1
 ◦ 63 MACH SURF. ROUGHNESS
 ◦ TOLERANCES ON:
 ◦ ANGLES: ± 5°
 ◦ DECIMALS: .xx ±.03
 .xxx ±.005

CONTRACT NO.		8011
APPROVALS	DATE	
DWN V. SANCHEZ	6/26/01	
CHK S. SETHI	6/27/01	
ENGR S. SETHI	6/27/01	

SAGEBRUSH Technology, Inc.
 A wholly-owned subsidiary of NextPath Technologies, Inc.

TOP- ASSEMBLY
 AERO 20

DO NOT SCALE DRAWING

SIZE	CAGE CODE	DWG NO.	REV.
D 0XTY1		DA03125	-
SCALE	WEIGHT	SHEET	1 OF 4

REPRESENTATIVE PAYLOADS

The elevation sphere radius is approximately 7.48", the payload volume is approximately 8 inches wide, 8 inches high, and 10 inches deep. Gimbal electronics and inertial instrument locations are payload-specific to help balance the payload. Additional ballast is added as-needed.

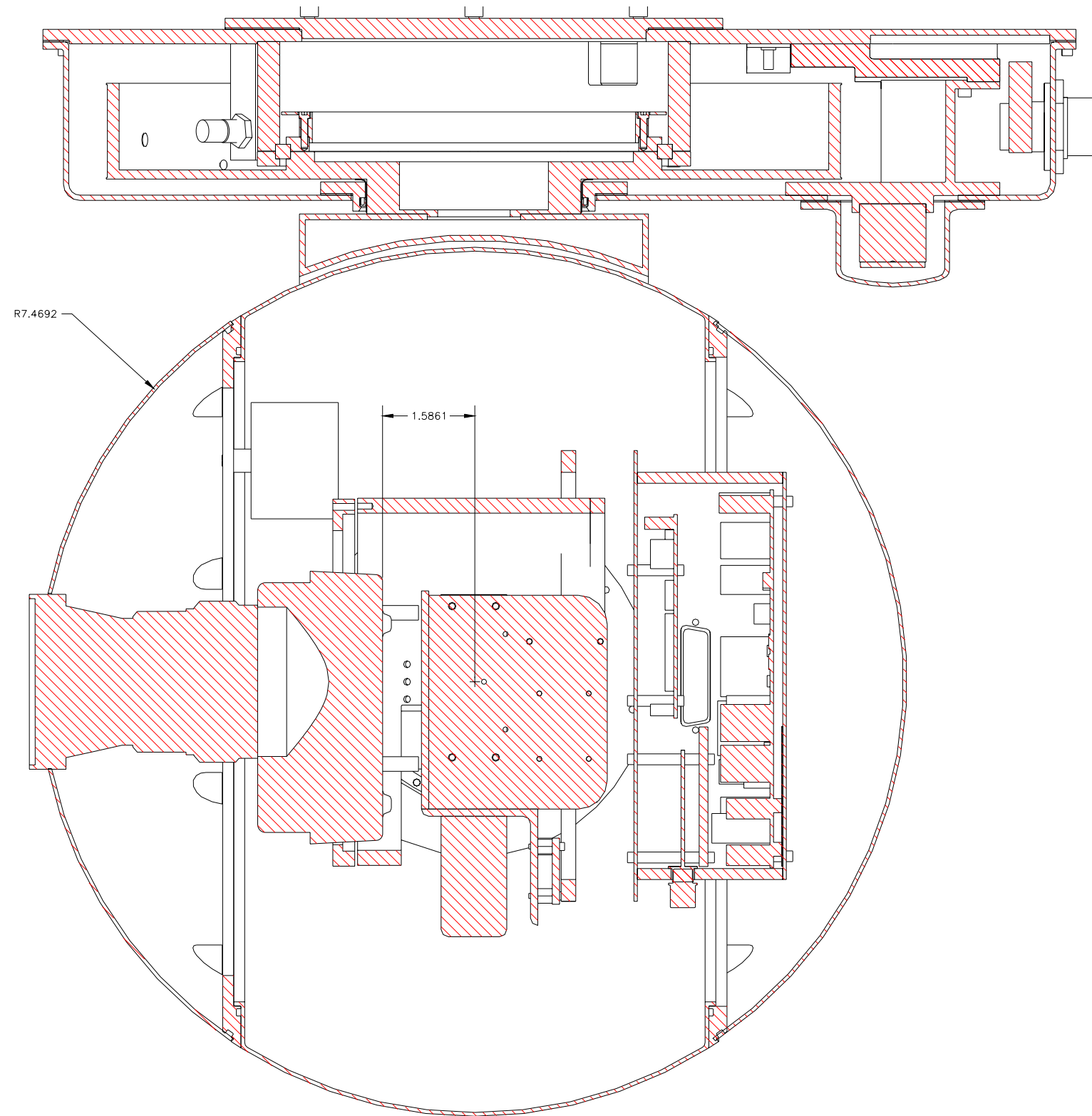

Cross-section of Raytheon 2000B Mount with 75mm lens. Camera is mounted approximately 1.59" forward of the sphere's center

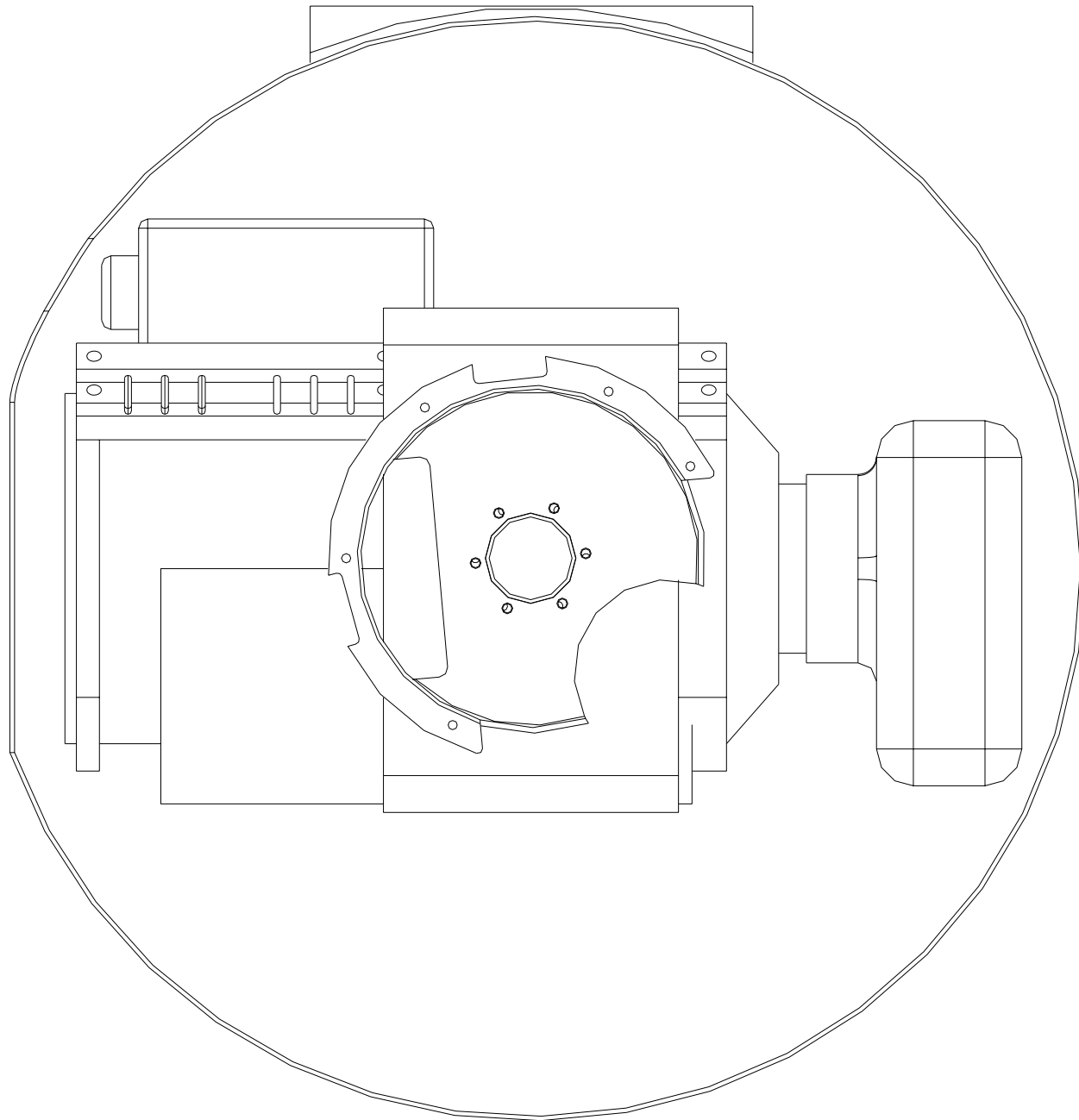

Cross-section of DIOP 50/150 mm Dual FOV lens with Raytheon 300 IR core. Daylight camera mounted above lens.
Inertial instruments and gimbal electronics not shown.

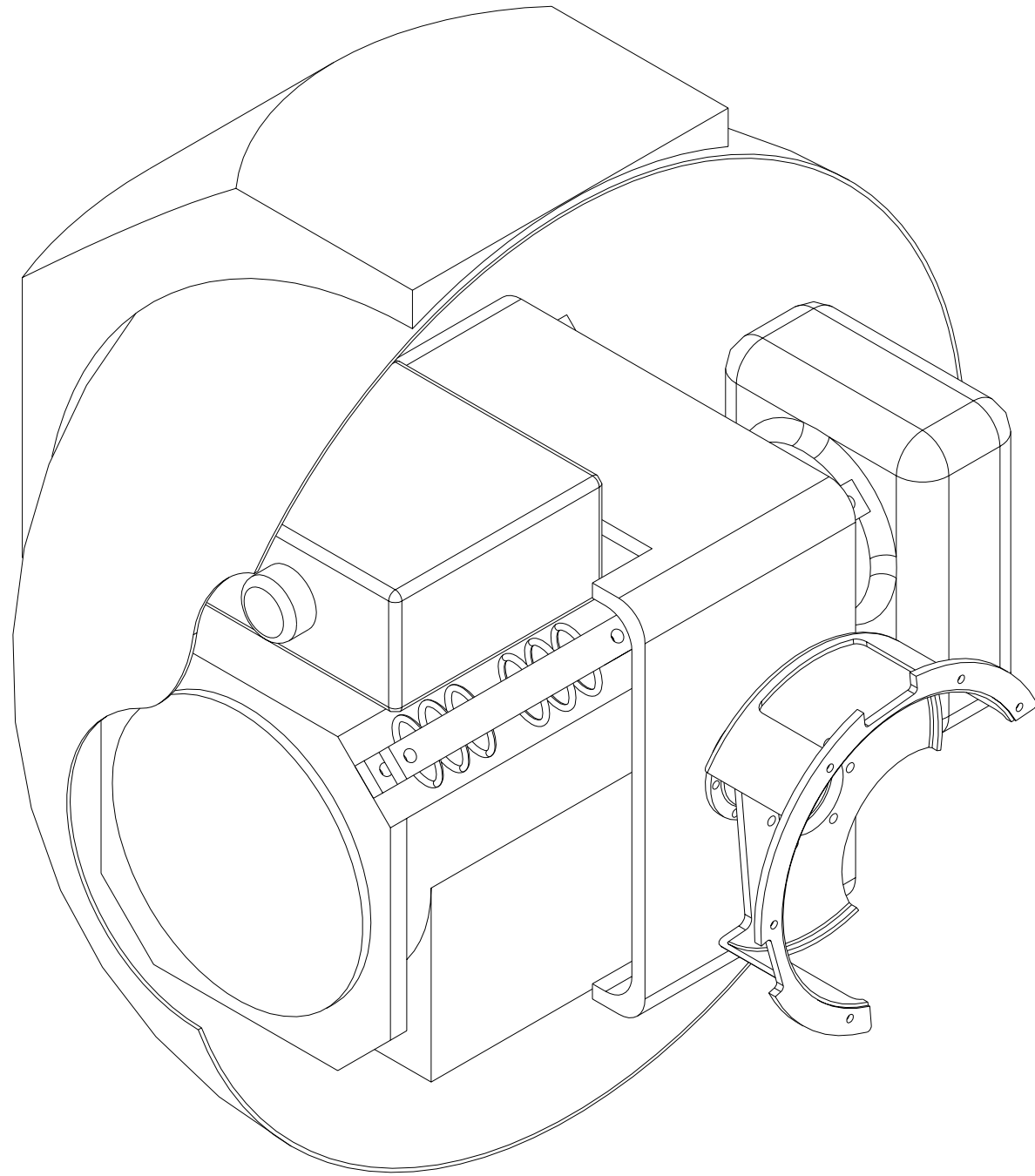

DIOP 50/150 mm Dual FOV lens with Raytheon 300 IR core. Daylight camera mounted above lens

Inertial instruments and gimbal electronics not shown